

11. Using an 8mm Spanner and 3mm Allen Key, tighten the Drive Shaft 'G' Fixing Bolts at both ends of the drive shaft.
IMPORTANT!
Ensure the RHS of the frame is lifted to the highest position possible before tightening the Drive Shaft Fixing Bolt

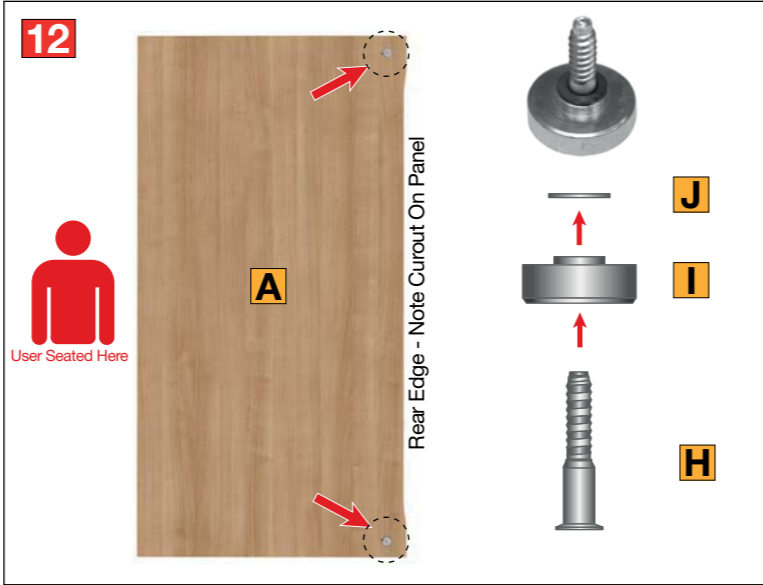

12. Locate items I, J & H screw fittings and screw onto the underside of both Top Panels 'A' (2 per top panel).

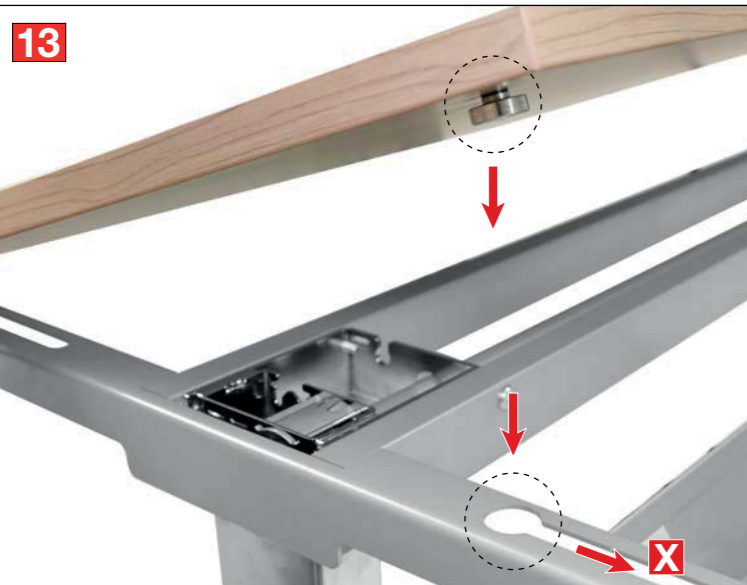

13. Locate each top above the keyhole slots in the Sub-Frame and slowly lower into place. Once located slide the top in the direction of arrow 'X'.

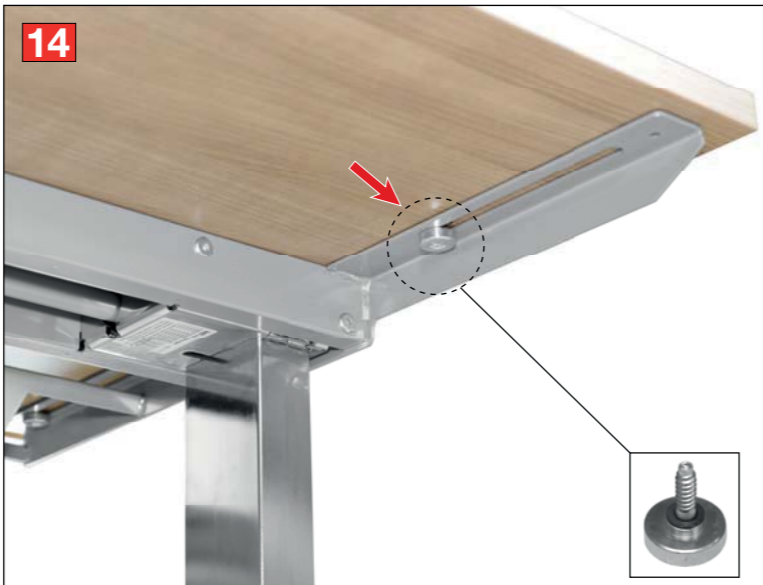

14. Insert and tighten the remaining 2 x 'H' fixings screws through the Sub-Frame and into the pre-drilled pilot hole in the Top Panel.

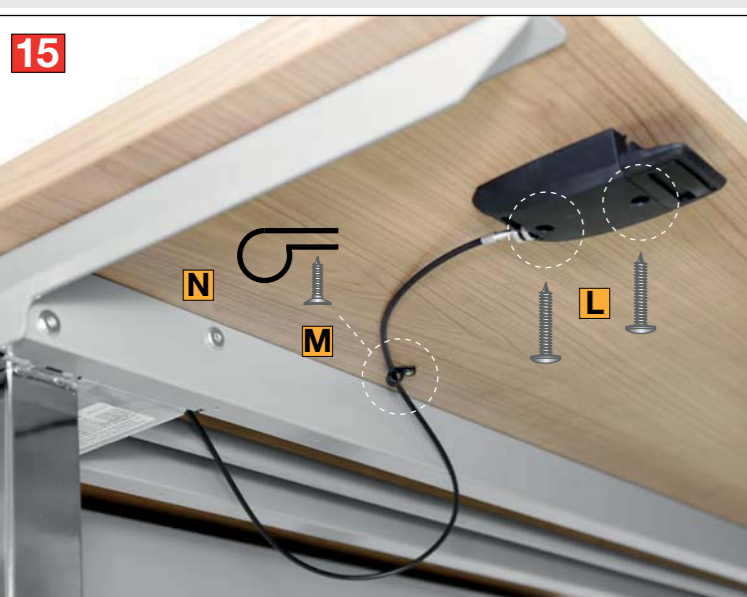

15. Attach the release lever to the underside of the top with 2 x 'L' Screws, pilot holes are pre-drilled for guidance. Fix the cable to the underside of the top as illustrated with the cable clip provided, see items 'N' & 'M'.



16. Progress Desk fully assembled. See additional instructions for Divider Screen attachment.

Range	Progress
Desk Style	Gas Strut Height Adjustable Double Bench
Before Assembly Please Read This Leaflet	2 Person Assembly
	Assembly Instructions



Tools Required				
	Pozi Screwdriver	3mm Allen Key or Hex' Screwdriver	4mm Allen Key or Hex' Screwdriver	8mm Spanner

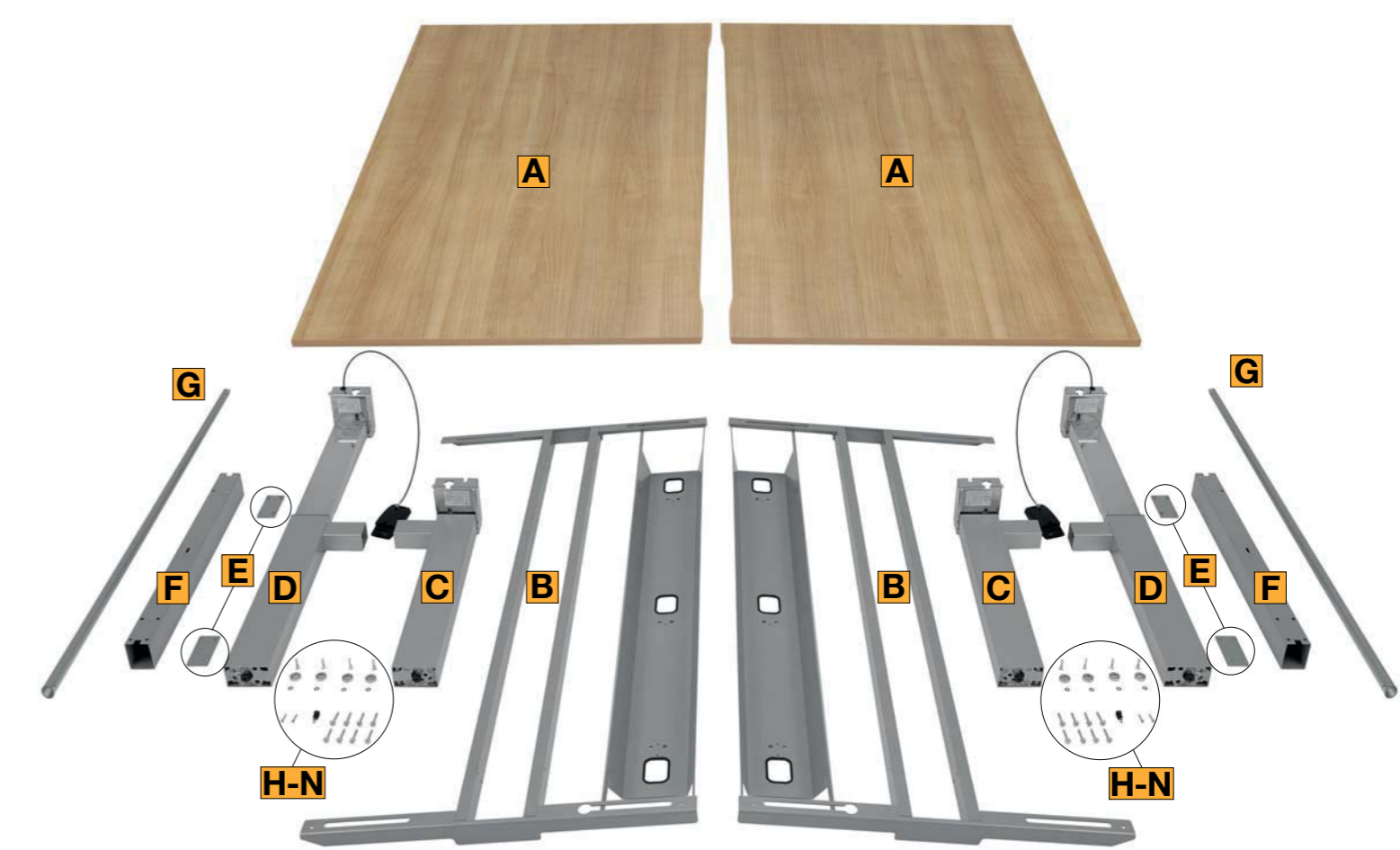

Components	
A Top Panel	x 2
B Sub-Frame & Integrated Horizontal Cable Tray	x 2
C Leg Support	x 2
D Leg Support – With Height Adjustment Lever	x 2
E Linking Plates	x 4
F Leg Support Cross Rail	x 2
G Drive Shaft – Leg to Leg Connection	x 2

Fittings Kit						
H	I	J	K	L	M	N
x 8	x 8	x 8	x 16	x 4	x 2	x 2

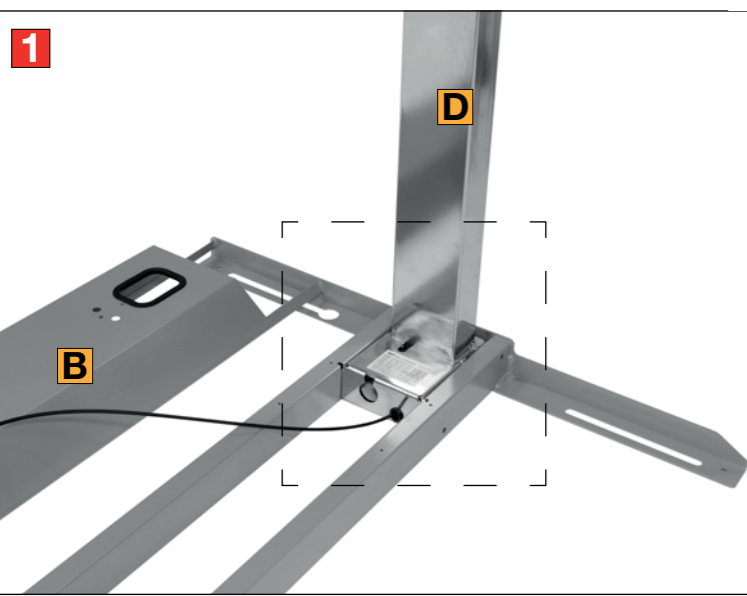

1. Lay Sub-Frame B on the floor
Locate Leg Support 'D' and extended fully. See image 1a.
Note the support leg with release lever & cable is to be placed as shown on the right hand side of the Sub-Frame.
(The release lever will be positioned on the left hand side of the top when the desk is upright).

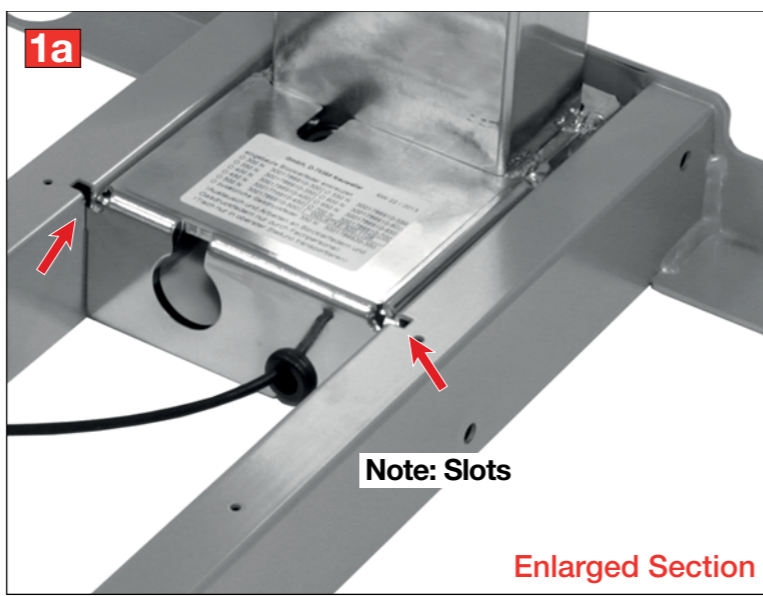

Enlarged Section

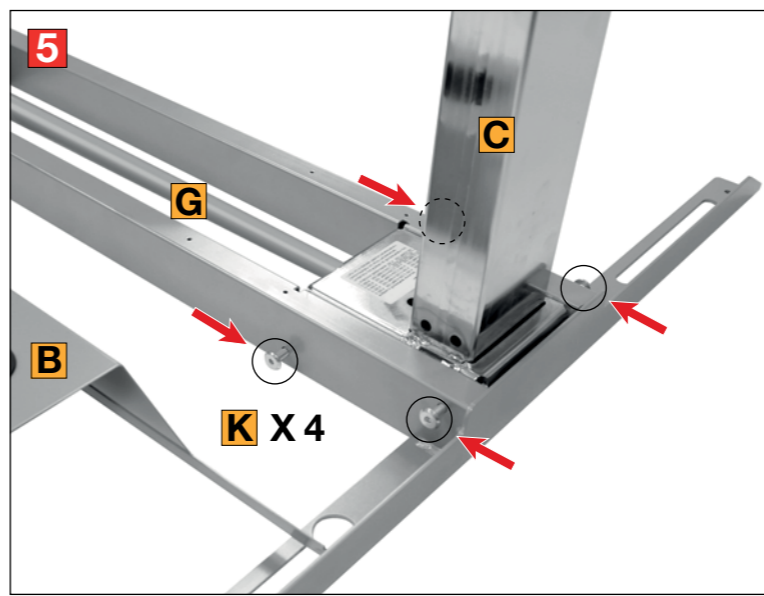

5. Insert fixing bolts 'K' through the Sub-Frame and into the Leg Support.

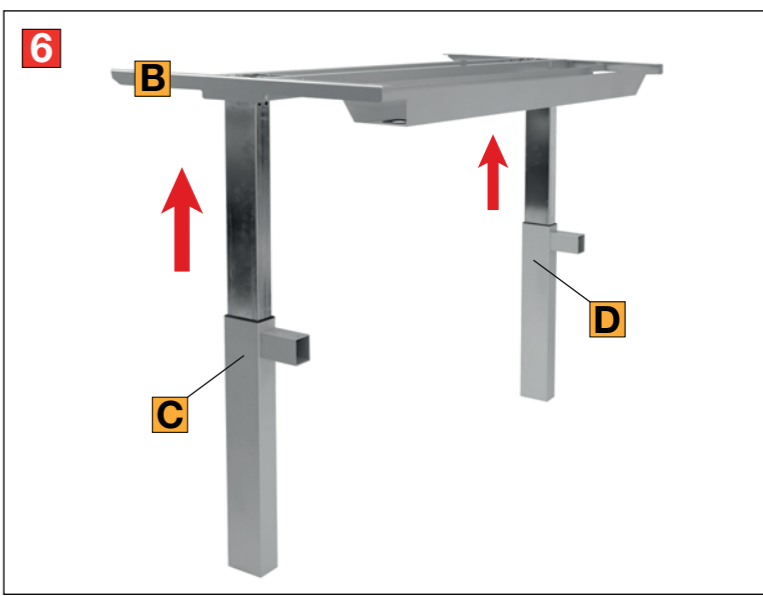

6. Stand the desk structure in the upright position, ensure the legs (C & D) are extended to the maximum height.

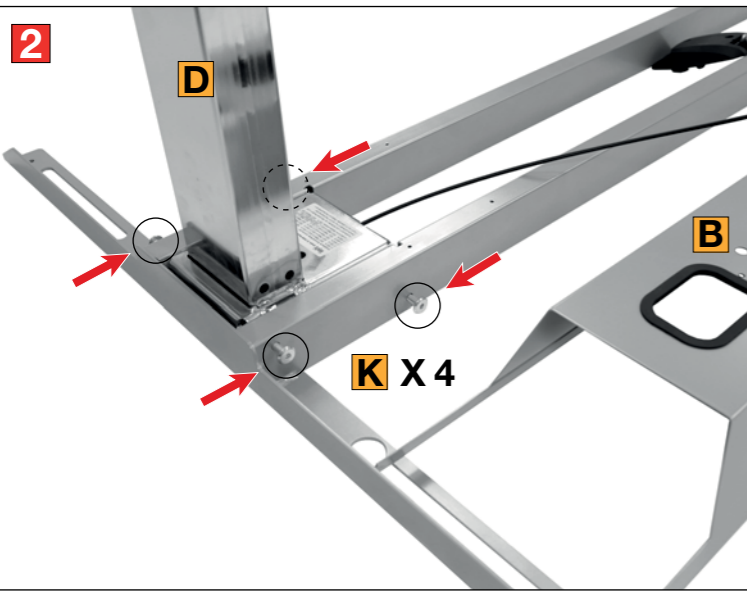

2. Secure Leg Support 'D' into Frame 'B' by 4 x Hex Bolts 'K'.

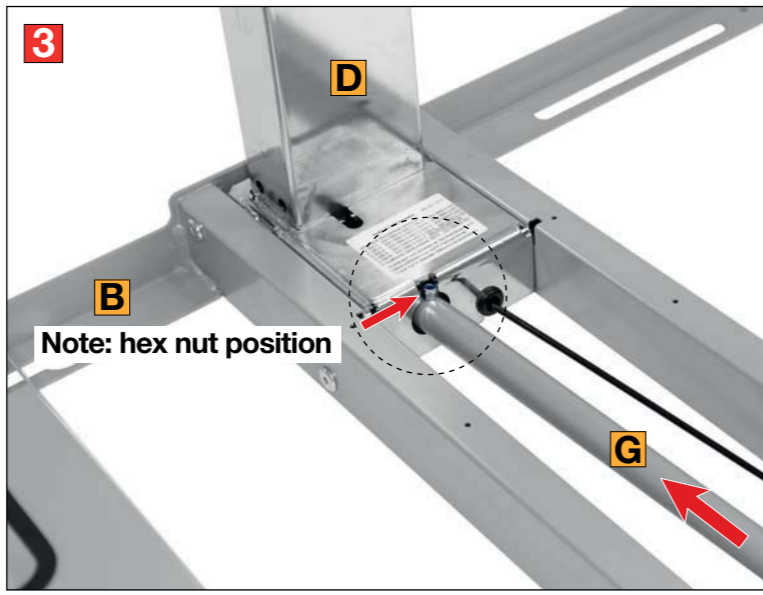

3. Locate the Drive Shaft 'G' and insert as shown above into Leg Support 'D' – Note the hex nut position facing up.



7. Assemble the other side of the double bench in the same way as procedures 1-6.

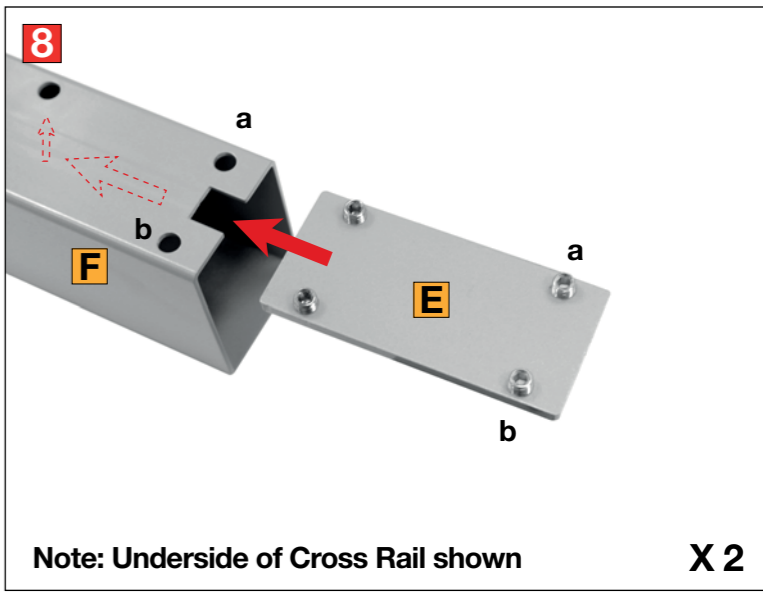

8. Locate the Leg Support Cross Rail 'F' and insert the Linking Plates 'E' as illustrated above. Ensure the plate is fully inserted with the screws a & b on plate 'E' in line with the holes on Leg Support Cross Rail 'F'.

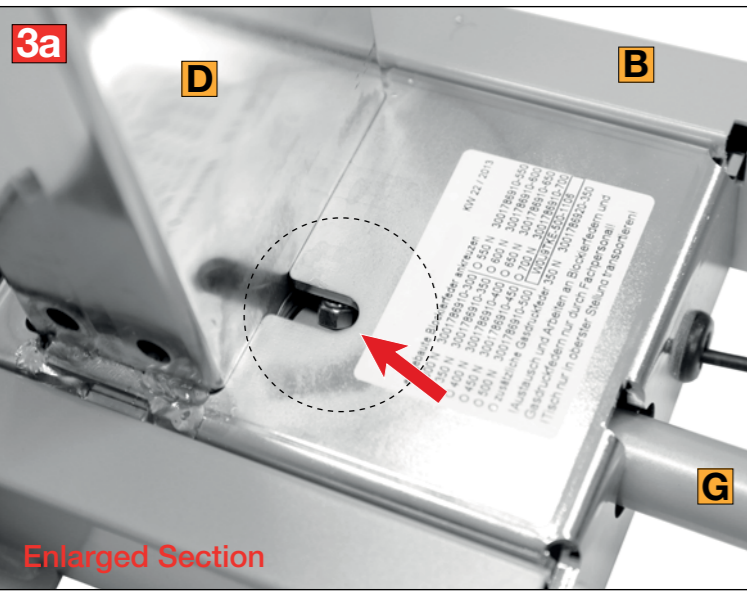

3a. Insert the Drive Shaft as far as it will travel.
Important: Keep the hex nut in the upright / facing position when inserting the Drive Shaft.

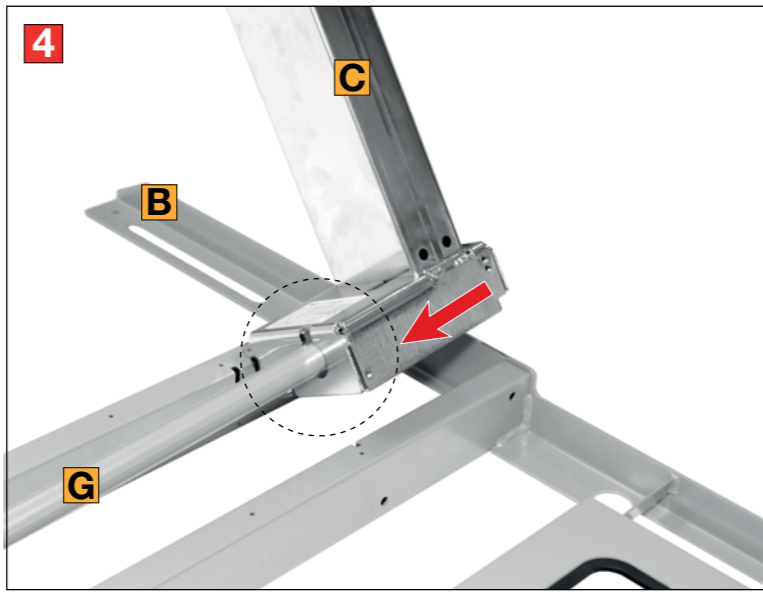

4. Insert the opposite end of the Drive Shaft into Leg Support 'C' as detailed above. Mirror the same process as detailed in image 3a.

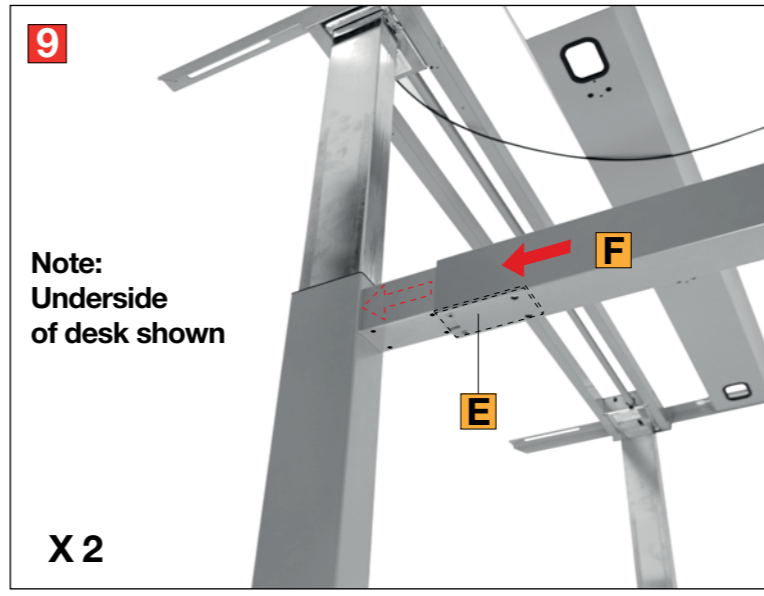

9. Slide the Leg Supports Cross Rail 'F' (with the attached plate 'E') onto both leg return spigots. Apply this to both sides of the desk frame.

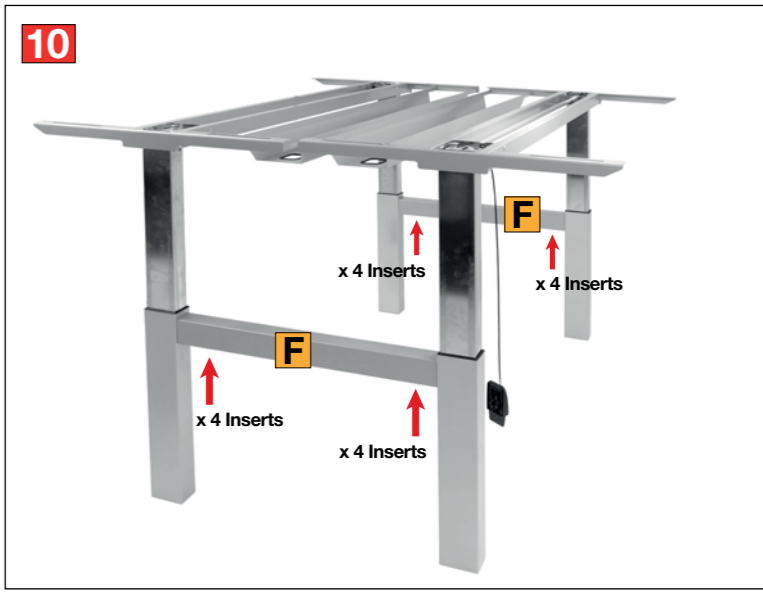

10. Mirror this on both Leg Support Cross Rails 'F'. Once the fixing screws have been tightened the workstations will stand unsupported.